

# MBRP

## MBRP Muffler Installation Instructions

126T209

2011-2018

REV XP / XM / MXZ / Summit / GSX  
Renegade / 800 E-TEC

**Note:** Local regulations may limit or prohibit modification to your snowmobile's emissions system and/or the sound levels that it generates. It is your responsibility to be aware of restrictions that may apply to your intended use of this product.

1. Remove the springs fastening the stock muffler to the frame and the exhaust pipe. (Set these springs safely aside so they can be reused.)
2. Remove the temperature sensor, then remove the stock muffler.
3. Install the MBRP muffler, placing its outlet through the stock exit in the belly pan.
4. Using the stock springs, fasten the MBRP muffler using the tabs on inlet pipe.
5. Using the two remaining stock springs and the provided spring extensions, fasten the MBRP muffler to the body. (Use the spring tabs on the top of the canister.)  
NOTE: 2013-2018 models require the shorter spring extension on the inlet side of the canister.
6. Reinstall the temperature sensor, 2011-2012 models will only require the adaptor.

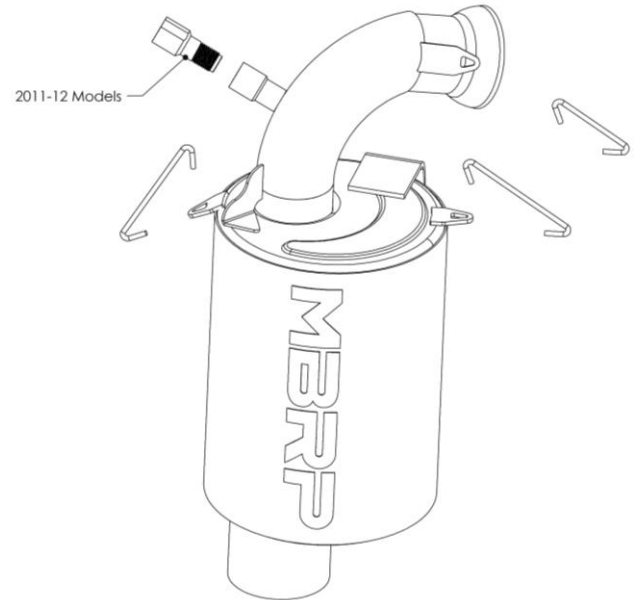

**NOTE:** To avoid exhaust leaks use a high heat silicone to seal all connections between the expansion chambers and the muffler. Monitor the exhaust for leaks during the first 200 miles after your installation and re-apply silicone where necessary. We suggest having your local snowmobile mechanic or performance shop install this product.

**CAUTION:** **DO NOT** touch the muffler while the snowmobile is running or shortly after it has run, as it may result in personal injury.

MBRP Ltd. warranty applies for a two (2) year period from the date of purchase to defects in product material and workmanship and is to the original purchaser on record and for the original vehicle for which it was designed and installed. This warranty is limited, at MBRP Ltd. sole determination, to the repair or replacement of defective product only and does not include the cost of removal or re-installation, damage by accident, abuse, misuse or misapplication or any consequential damages however they may arise. Determination of warranty coverage shall be at the discretion of an authorized MBRP Ltd. quality engineer.